

# TT101FTURBO

HD Passive Video Balun

**epcom**  
**TITANIUM**



## ► Features

Single Channel HD Passive Video Balun

Real-time transmission over UTP cat5e/6

No power required

NTSC, PAL & SECAM video format compatible

Compatible with all TurboHD cameras

Color video max up to 230m(754ft) for TurboHD 720P analog camera

Color video max up to 250m(820ft) for TurboHD 1080P analog camera

Male BNC connector

Reliable push-pin terminal connection for UTP cable

Built-in TVS (Transient Voltage Suppressor) for surge protection

Wave Filter Design, Anti-Static Design

Lightning protection design Grade: III

60 dB crosstalk and noise immunity

Exceptional interference rejection

ABS engineering plastic housing

## ► Overview

Unshielded Twisted Paired (UTP) cable. Baseband (composite) signals of any type are supported. The TT101FTURBO is compatible with all HD-TVI, HD-CVI and AHD analog camera. Male BNC of the TT101FTURBO allows connection directly to the camera and DVR. Screw-less terminal block allows tool-less connection of UTP cable output. Used in pairs, the TT101FTURBO eliminates costly and bulky coaxial cable. The superior interference rejection and low emissions of the TT101FTURBO allow video signals to coexist in the same wire bundle as telephone, datacom, or low-voltage power circuits. This allows the use of a shared or existing cable plant. The TT101FTURBO is built-in surge suppressor to protect video equipment against damaging voltage spikes. Its crosstalk and noise immunity ensure quality video signals.

## ► Wire and Cable Recommendations

The TT101FTURBO is recommended to use with Unshielded Twisted Paired (UTP) wiring from 24AWG through 22AWG. Individually shielded pairs should be avoided, as they reduce the operating range of the systems drastically. Multi-pair cable (25-pair or more) with an overall shield are acceptable. Video signals can coexist in the same wire bundle as telephone, datacom, or low-voltages power circuits. While video may be routed through telephone punch-down block terminals, any bridge-taps, also called T-taps and any resistive, capacitive or inductive devices **MUST BE** removed from the pair.

For more specific information regarding wire types, gauges and proper installation techniques, please contact us for technical assistance.

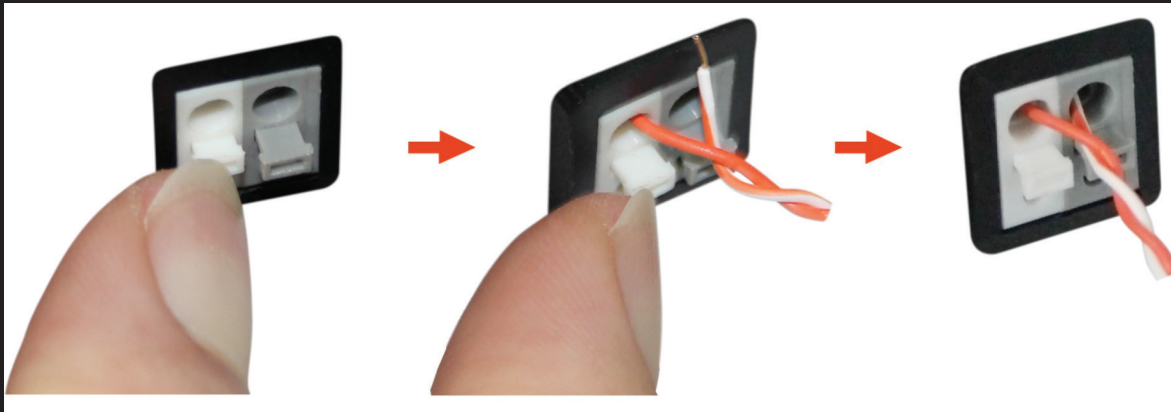

Wire	Pin #	Configuration
Orange White	1	Video (+)
Orange	2	Video (-)
Green White	3	Power (-)
Blue	4	Power (-)
Blue White	5	Power (-)
Green	6	Power (+)
Brown White	7	Power (+)
Brown	8	Power (+)

### Note:

1. The transmitter and receiver must use the same wiring.
2. If you adjust saturation of DVR, video transmission distance could be farther.
3. If chromatic aberration occurs within 30 meters, please also adjust saturation, the picture will recover perfectly automatically.
4. The above data is only the result of laboratory test; actual distance will depend on the camera's inrush and operating current, minimum operating voltage, the wire's quality and environmental factors.